

OPERATING INSTRUCTIONS AND PARTS MANUAL

# MODEL PS-16

## Stapler

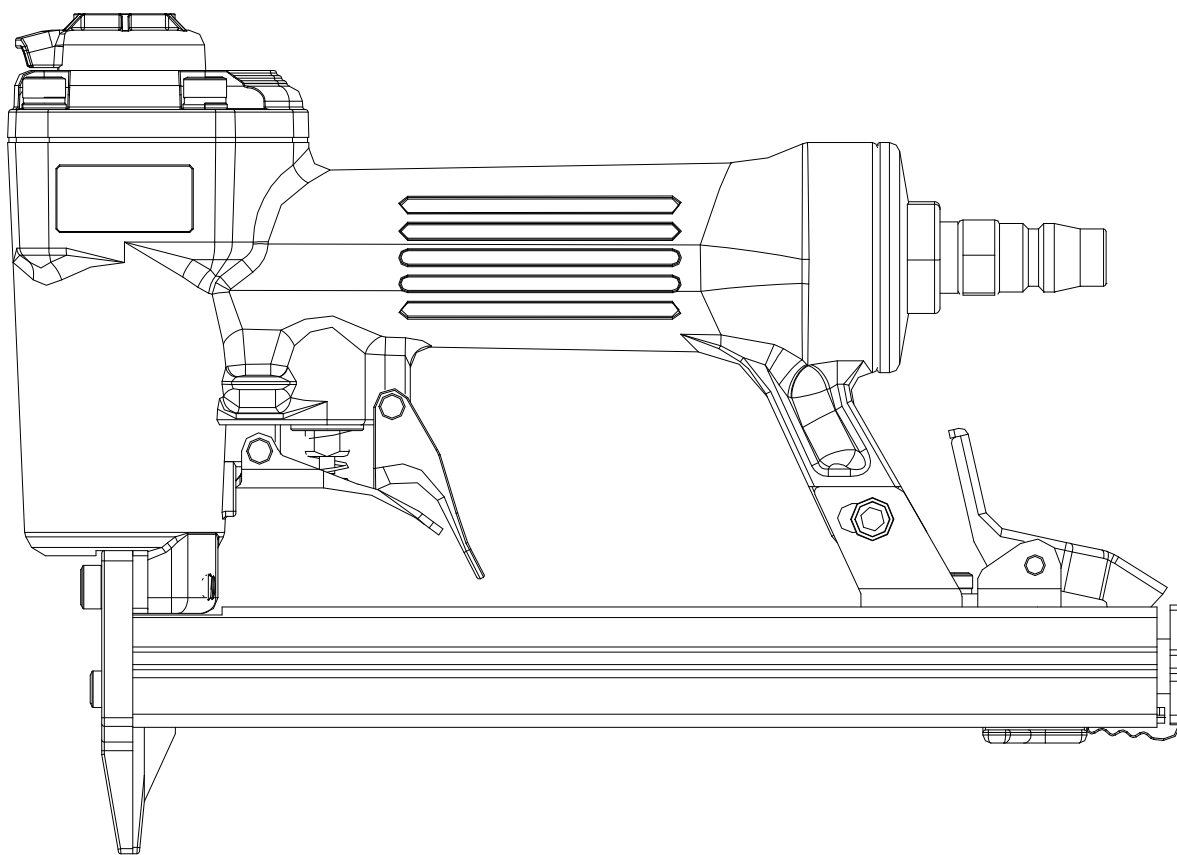

CAREFULLY READ THIS MANUAL BEFORE OPERATING TOOL

**APLUS Pneumatic Corp.**  
NO.579, SEC. 1, SHEN LIN RD., TAYA, TAICHUNG CITY 428 TAIWAN, R.O.C.  
Tel: 886-4-25602860 Fax: 886-4-25602859  
Original instructions

OPERATING INSTRUCTIONS AND PARTS MANUAL

# MODEL PS-16

## Stapler

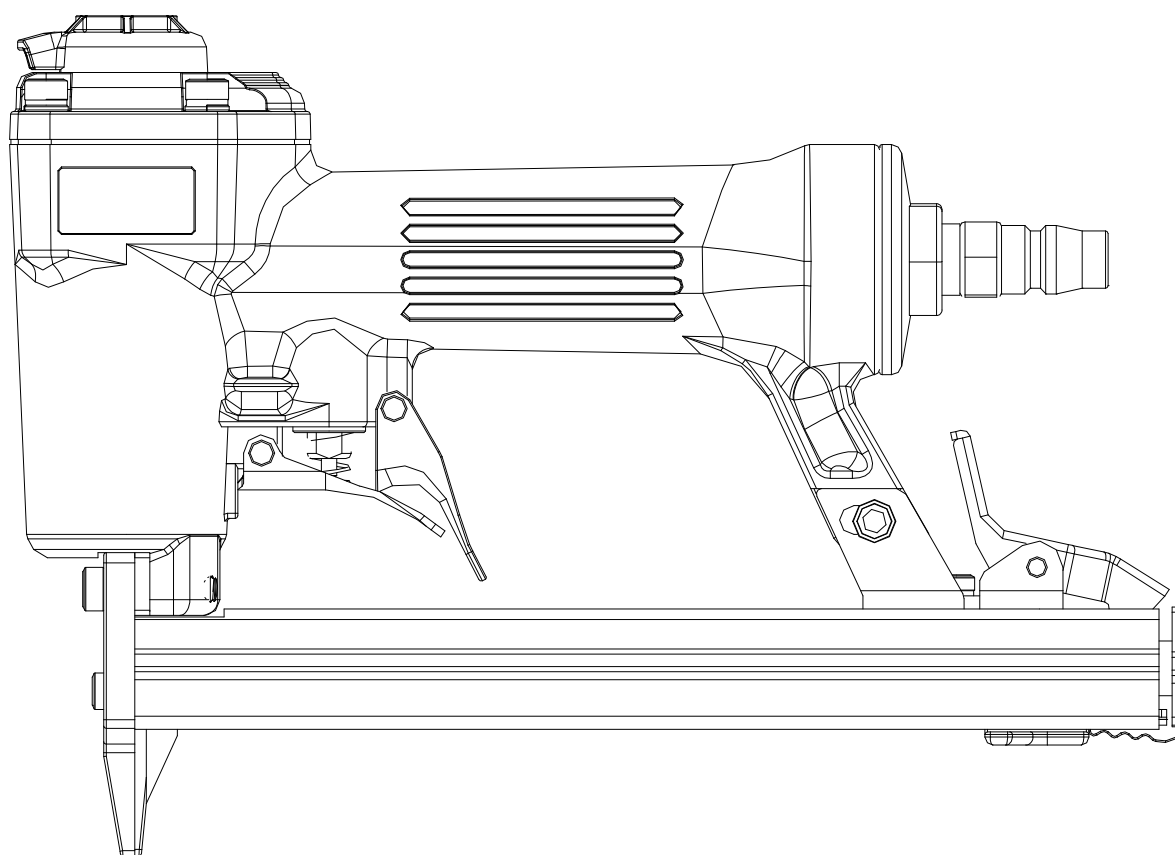

CAREFULLY READ THIS MANUAL BEFORE OPERATING TOOL

## TOOL SPECIFICATIONS

MODEL OF TOOL .....	PS-16
TOOL LENGTH .....	8.86" (225 mm)
TOOL HEIGHT .....	6.10" (155 mm)
TOOL WIDTH .....	1.77" (45 mm)
WEIGHT (WITHOUT FASTENERS) .....	1.98 lbs (0.9 kg)
AIR INLET .....	1/4" NPT

### COMPRESSED AIR :

Maximum permissible operating pressure .....	110 PSIG (7.5 bar)
Recommended operating pressure range .....	60 ~ 100 PSIG (4 ~ 7 bar)
AIR CONSUMPTION.....	0.0043 scfm with 25 nails per minute @ 100 psi (6.9 bar)

### Noise dB(A) :

A-weighted sound pressure level LpA.....	85.29 dB(A)
A-weighted sound power level LwA.....	98.29 dB(A)

Measurement uncertainty: 3dB

### Vibration (m/s<sup>2</sup>) :

Hand-arm vibration value.....	2.36 m/s <sup>2</sup>
Measurement uncertainty:	1.5 m/s <sup>2</sup>

### Warning:

The vibration emission during actual use of the power tool can differ from the declared total value depending on the ways in which the tool is used; and of the need to identify safety measures to protect the operator that are based on an estimation of exposure in the actual conditions of use (taking account of all parts of the operation cycle such as the times when the tool is switched off and when it is running idle in addition to the trigger time).

List of fasteners for PS-16 :

Crown	Thickness	Width	MAGAZINE
12.7 mm	1.1 mm	1.25 mm	160 pcs
0.5 "	0.043 "	0.049 "	

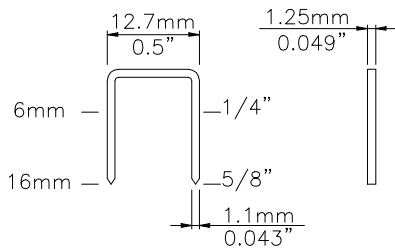

### Foreword:

This stapler drives composite staples which fasten work piece tightly. It has been designed for comfort and ease of use, lightweight, and well-balanced.

### Suitable applications:

Furniture, wooden cabinets, door and window trims, boatbuilding, woodworking.

### Caution:

This stapler mainly implement on soft material fastening. The tool will be damaged if use on metal material fastening.



Indicates an imminently hazardous situation which, if not avoided, will result in death or serious injury.

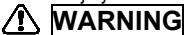

Indicates a potentially hazardous situation which, if not avoided, will result in death or serious injury.



Alerts the operator to useful information.

## SAFETY INSTRUCTIONS



1. Read this manual and understand all safety instructions before operation the tool. If you have any questions, please contact our authorized representatives.
2. Only those fasteners listed in the operating instructions may be used in the fastener driving tools.
3. Only the main energy and the lubricants listed in the operating instructions may be used.
4. Fastener driving tools marked with an inverted equilateral triangle standing on one point may only be used with an effective safety yoke.
5. Fastener driving tools equipped with contact actuation or continuous contact actuation, marked with the symbol " Do not use on scaffoldings, ladders", shall not be used for specific application for example:
  - when changing one driving location to another involves the use of scaffoldings, stairs, ladders, or ladder alike constructions, e.g. roof laths,

—closing boxes or crates,

—fitting transportation safety systems e.g. on vehicles and wagons.

6. For the maintenance of fastener driving tools, only spare parts specified by the manufacturer or his authorized representative shall be used.
7. Repairs shall carried out by agents authorized by the manufacturer or by other specialists, having due regard to the information given in the operating instruction.
8. Stands for mounting the fastener driving tools to a support for example a work table shall be designed and constructed by the stand manufacturer in such a way that the fastener driving tool can be safely fixed for the intended use, thus for example avoiding damage, distortion or displacement.
9. Fastener driving tools operated by compressed air shall only be connected to compressed air lines where the maximum allowable pressure cannot be exceed by a factor of more than 10%, which can for example be achieved by a pressure reduction valve which includes a downstream safety valve.
10. When using fastener driving tools operated by compressed air, particular attention must be paid to avoid exceeding the maximum allowable pressure.
11. When using fastener driving tools operated by compressed air should only be operated at the lowest pressure required for the work process at hand, in order to prevent unnecessarily high noise levels, increased wear and resulting failures.
12. Hazards caused by fire and explosion when using oxygen or combustible gases for operating compressed air operated fastener driving tools.
13. Carry the fastener driving tool at workpiece using only the handgrip, and never with the trigger actuated. Never carry the tool by the hose or pull the hose to move the tool.

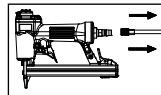

14. Disconnect the tool from air supply before cleaning jams, servicing, adjusting, and during non-operation.



15. Wear eye protection.

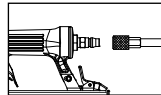

16. Do not use a check valve or any other fitting which allows air to remain in the tool.



17. Do not place your hand or any part of your body in the fastener discharge area of the tool when connecting or disconnecting air supply.



18. Never point tool at yourself or at any other person.

## AIR SUPPLY AND CONNECTION

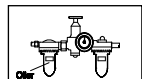

• Many air tool users find it convenient to use oiler to help provide oil circulation through tool and increase the efficiency and useful life of the tool. Check oil level in the oiler daily.

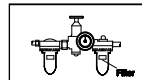

• Many air tool user find it convenient to use a filter to remove liquid and impurities which can rust or wear internal parts of the tool. A filter also increase the efficiency and useful of the tool. The filter must be checked on a daily basis and if necessary drained.

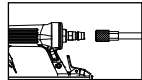

• For better performance, install a 3/8" quick connector (1/4" NPT threads) with an inside diameter of .315" on your tool and a 3/8" quick coupler on the air hose.

The following illustration shows the correct mode of connection to the air supply system which will increase the efficiency and useful life of the tool.

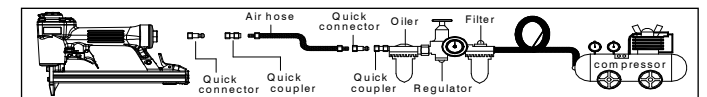

## LUBRICATION AND MAINTENANCE

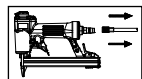

- Disconnect the air supply from the tool before lubricating.



- Your tool requires lubrication before you use it for the first time.

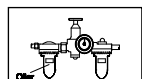

• Wipe off excessive oil at the exhaust. Excessive oil will damage O-rings of tool. If in-line oiler is used, manual lubrication through the air inlet is not required on a daily basis.



• Turn the tool so the inlet is facing up and put one drop of high speed spindle oil, UNOCAL RX22, or 3-IN-1 oil into air inlet. Never use detergent oil or additives. Operate the tool briefly after adding oil.

## LOADING THE TOOL

### ⚠️ WARNING



- Do not place your hand or any part of your body in the fastener discharge area of the tool when connecting or disconnecting air supply.

### ⚠️ WARNING



- Never point any operational fastener driving tool at yourself or at any other person.

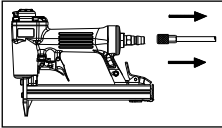

1. Disconnect air hose.

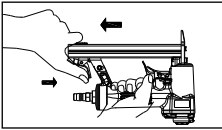

2. Depress the magazine latch. Pull back on the magazine cover.

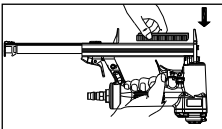

3. Insert a stick of fasteners into the magazine. Make sure the pointed ends of the fasteners are loaded with the points upward. Also make sure fasteners are not dirty or damaged.

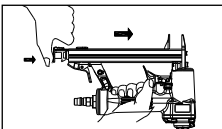

4. Push the magazine cover forward until the latch catches.

## OPERATING THE TOOL

### ⚠️ WARNING



Protect your eyes and ears. Wear z87.1 safety glasses with side shields. Wear hearing protection. Employers and users are responsible for ensuring the user or anyone near the tool wear this safety protection.

### ⚠️ NOTE

Check and replace any damaged or worn components on the tool. The safety warning labels on the tool must also be replaced if they are not legible.



Fig.1

1. Add a few drops of UNOCAL RX22 or 3-in-1 oil into the air inlet. (See Fig. 1)

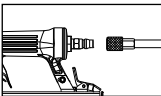

Fig.2

2. Attach a high flow quick connect fitting to the tool. (See Fig. 2)

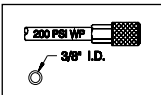

Fig.3

3. Empty the magazine.
4. Connect the tool to an air compressor using a 3/8" I.D hose. Make sure the hose has a rated working pressure exceeding 200 PSI (13.8bar) and a female quick coupler. (See Fig. 3)

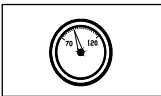

Fig.4

5. Regulate the air pressure to obtain 70 PSI (4.8 bar) at the tool. (See Fig. 4)

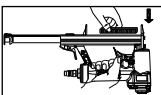

Fig.5

6. Disconnect the air supply from the tool.

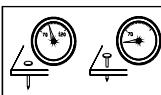
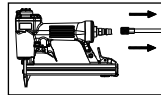

Fig.6

7. Load fasteners into your tool following the instructions in this manual. (See Fig. 5)
8. Reconnect the air supply to the tool.
9. Test for proper fastener penetration by driving nails into a sample piece of wood. If the fasteners do not achieve the desired penetration, adjust the air pressure to a higher setting until the desired penetration is achieved. Do not exceed 110 PSI (7.6 bar) at the tool. (See Fig. 6)

## CLEARING A JAM FROM THE TOOL

### ⚠️ WARNING



Disconnect the tool from air compressor before adjusting, clearing jams, servicing, relocating and during non-operation.

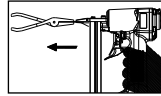

1. Fastener jammed in fastener discharge area:
  - Disconnect tool from air hose.
  - Grab jammed fastener with pliers and remove.

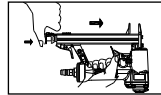

2. Fastener jam inside magazine:
  - Disconnect air tool from air hose.
  - Pull back on fastener pusher until locked.
  - Removed jammed fastener.
  - Release fastener pusher.

## CLEANING THE TOOL

### ⚠️ DANGER



Never use gasoline or other flammable liquids to clean the tool. Vapors in the tool will ignite by a spark and cause the tool to explode and result in death or serious personal injury.

### ⚠️ NOTE

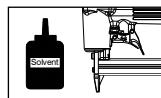

Solvents used to clean the nose of the tool and contact safety trip mechanism may soften the tar on the shingles and cause the buildup to be accelerated. Make sure to dry the tool thoroughly after cleaning and before operating the tool again.

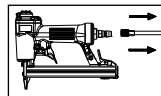

1. Disconnect the air supply from the tool.

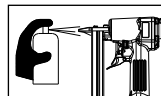

2. Remove tar buildup with kerosene #2 fuel oil or diesel fuel. Do not allow solvent to get into the cylinder or damage may occur. Dry off the tool completely before use.

## TROUBLESHOOTING

Stop using the tool immediately if any of the following problems occur. Serious personal injury could. Any repairs or replacements must be done by a qualified person or an authorized service center only.

PROBLEM	PROBABLE CAUSE	REMEDY
Air leaking at trigger valve area.	O-rings in trigger valve housing are damaged.	O-rings must be replaced.
Air leaking between housing and nose.	Loose screws in housing.	Screws need to be tightened.
Air leaking between housing and cap Assy.	Damaged to bumper.	O-rings must be replaced.
	Damage to bumper.	Bumper needs to be tightened.
	Loose screws.	Screws need to be tightened.
	Damaged seal.	Seal needs to be replaced.
Tool skips driving fastener.	Worn bumper.	Bumper needs to be replaced.
	Dirt in nose.	Clean.
	Dirt or damage prevents fasteners from moving freely in magazine.	Magazine needs to be cleaned.
	Inadequate air flow to tool.	Fitting hose or air compressor needs to be checked.
	Worn O-ring on piston or lack of lubrication.	O-ring needs to be replaced. Lubricate.
Tool runs slow or has loss of power.	Damaged O-rings on trigger valve.	O-rings need to be replaced.
	Air leaks.	Screws and fittings need to be tightened.
	Cap seal leaking.	Seal needs to be replaced.
	Tool not lubricated sufficiently.	Tools needs to be lubricated.
Fasteners are jammed in tool.	Broken spring in cap Assy.	Spring needs to be replaced.
	Exhaust port in cap is blocked.	Damaged internal parts need to be replaced.
	Driver nozzle worn or damaged.	Replace driver nozzle.
Fasteners are jammed in tool.	Driver is damaged.	Replace driver.
	Fasteners are not correct size.	Fasteners recommended for tool must be used.
	Fasteners are bent.	Replace with undamaged fastener.
	Magazine or nose screws are loose.	Screws need to be tightened.

# PS-16A02 (MX/A1-02)

e

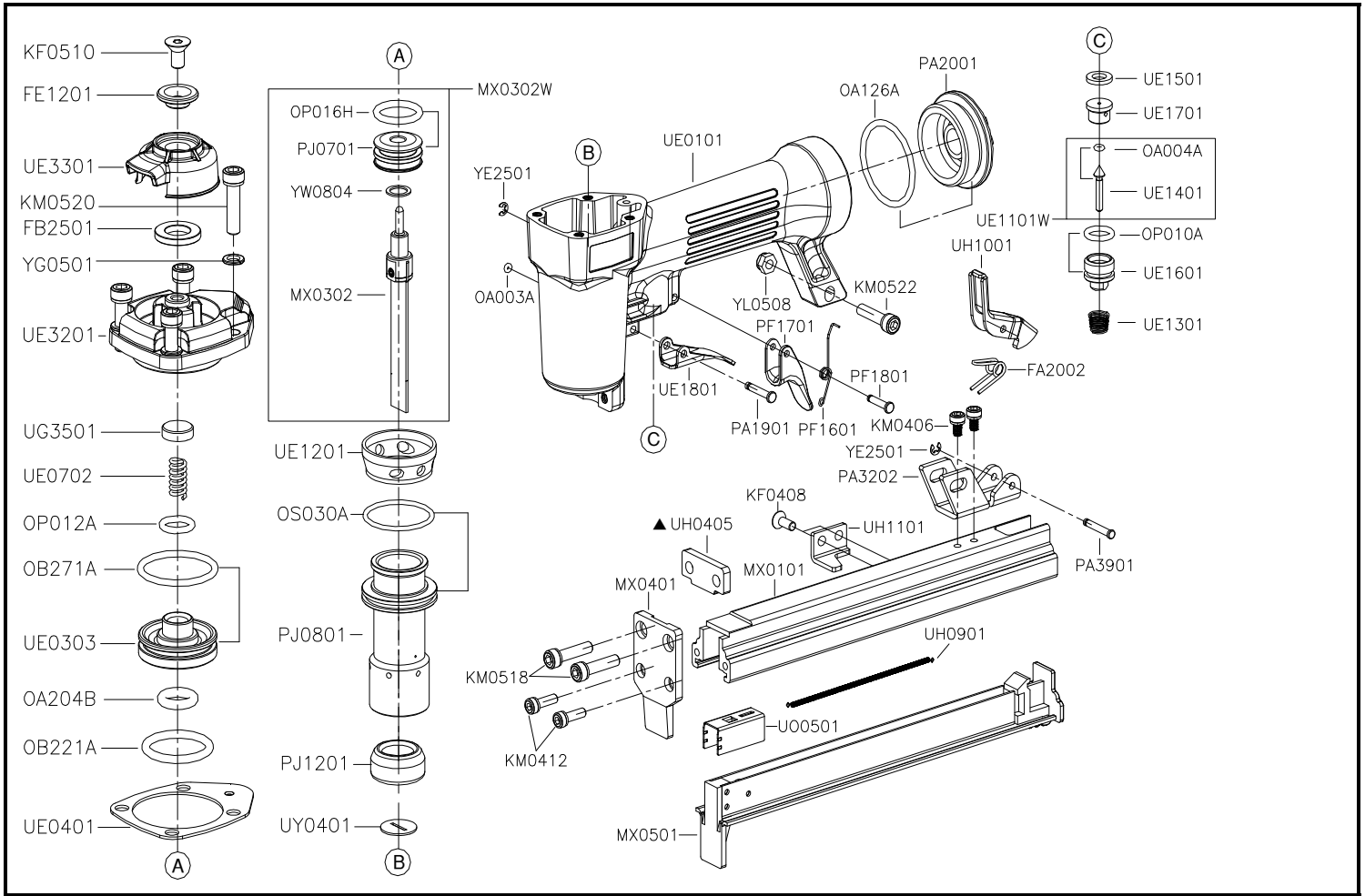

Part_No	Description	Spec	Q'ty	Part_No	Description	Spec	Q'ty	Part_No	Description	Spec	Q'ty
FA2002	SPRING		1	OP012A	O-RING	P12	1	UE1601	TRIGGER VALVE GUIDE		1
FB2501	PISTON STOP		1	OP016H	O-RING	15.8×2.4	1	UE1701	TRIGGER VALVE SEAT		1
FE1201	EXHAUST CAP RING		1	OS030A	O-RING	S-30	1	UE1801	TRIGGER		1
KF0408	FLAT HD.BOLT	M4×0.7 - 8L	2	PA1901	PIN		1	UE3201	CYLINDER CAP		1
KF0510	FLAT HD.BOLT	M5×0.8 - 10L	1	PA2001	END CAP		1	UE3301	EXHAUST CAP		1
KM0406	HEX.SOC.HD.BOLT	M4×0.7 - 6L	2	PA3202	SUPPORT		1	UG3501	PISTON STOP		1
KM0412	HEX.SOC.HD.BOLT	M4×0.7 - 12L	2	PA3901	PIN		1	▲ UH0405	GUIDE PLATE		1
KM0518	HEX.SOC.HD.BOLT	M5×0.8 - 18L	2	PF1601	SPRING		1	UH0901	PULL SPRING		1
KM0520	HEX.SOC.HD.BOLT	M5×0.8 - 20L	4	PF1701	SAFETY LEVER		1	UH1001	LATCH		1
KM0522	HEX.SOC.HD.BOLT	M5×0.8 - 22L	1	PF1801	PIN		1	UH1101	MAGAZINE RETAINER		1
MX0101	MAGAZINE CAP		1	PJ0701	MAIN PISTON		1	UO0501	PUSHER		1
MX0302	DRIVER SET		1	PJ0801	CYLINDER		1	UY0401	NOZZLE		1
MX0302W	DRIVER ASSY.		1	PJ1201	BUMPER		1	YE2501	E-RING	φ2.5	2
MX0401	COVER PLATE		1	UE0101	BODY		1	YG0501	SPRING WASHER	φ5	4
MX0501	MAGAZINE SEAT SET		1	UE0303	HEAD VALVE PISTON		1	YL0508	LOCK NUT	M5×0.8	1
OA003A	O-RING	ARP568-003	1	UE0401	CAP SEAL		1	YW0804	FLAT WASHER	φ8,T=0.5mm	1
OA004A	O-RING	ARP568-004	1	UE0702	COMPRESSION SPRING		1				
OA126A	O-RING	ARP568-126	1	UE1101W	TRIGGER VALVE ASSY.		1				
OA204B	O-RING	ARP568-204	1	UE1201	COLLAR		1				
OB221A	O-RING	22×3	1	UE1301	COMPRESSION SPRING		1				
OB271A	O-RING	26.8×2.4	1	UE1401	TRIGGER VALVE STEM		1				
OP010A	O-RING	P10	1	UE1501	SEAL		1				

★☆☆ If you need to order parts, please mark both Parts No. and Description. ☆☆☆