

# F21PL-E

## PNEUMATIC STICK NAILERS

### CLAVADORA NEUMÁTICA ALIMENTADA POR BARRA CLOUEUR PNEUMATIQUE EN BANDES

SEE REVERSE SIDE FOR AVAILABLE  
ACCESSORIES (NOT INCLUDED)

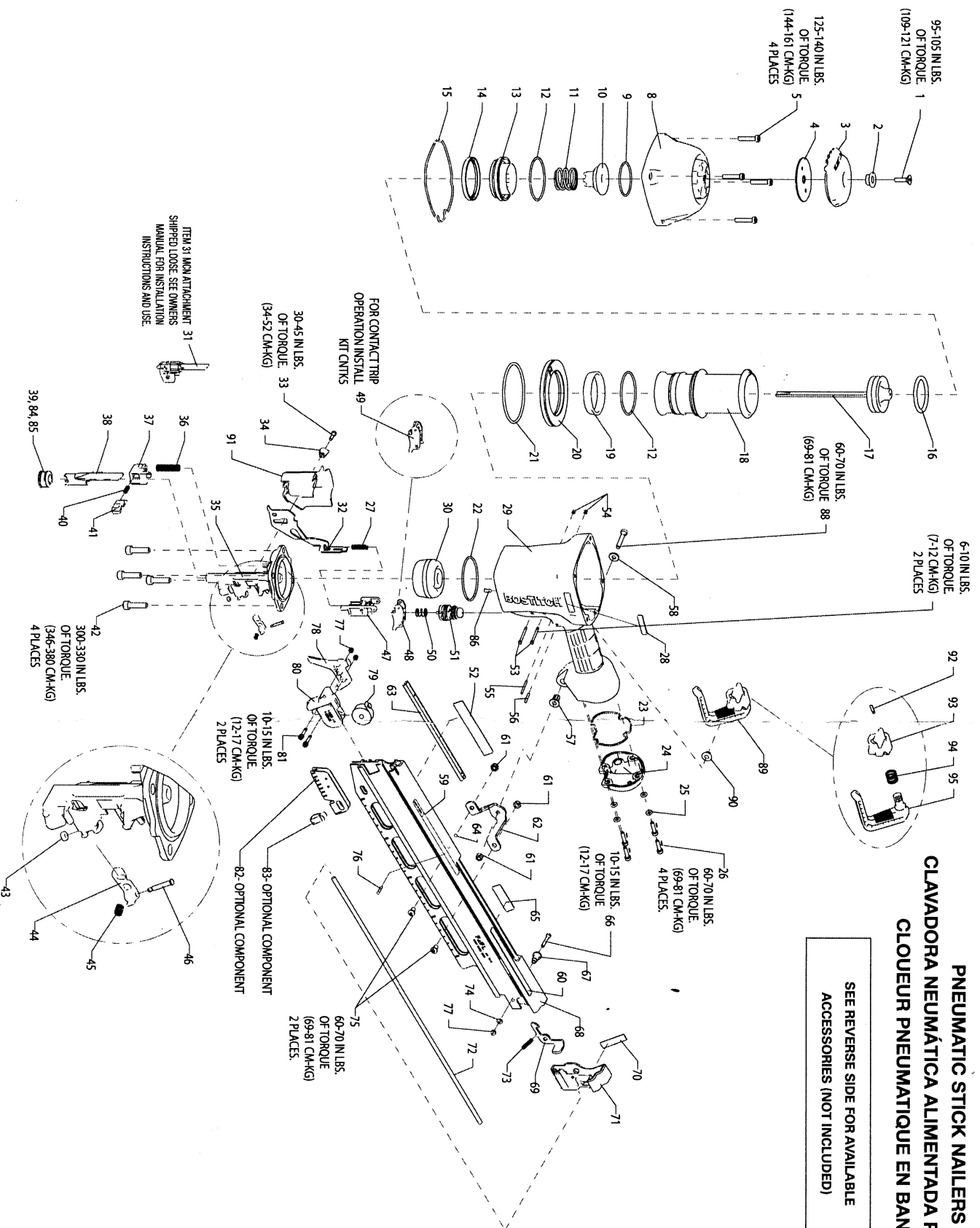

BOSTITCH

F21PL-E

Parts List: IP1343-2RC

To be Used with tool parts illustration: IP1343-1RB

and operation and maintenance manual: 196538

Serial Number on the Tool: F21PL-E 13 201 000 and Higher

ITEM	PART #	DESCRIPTION	ITEM	PART #	DESCRIPTION
1	MSF100-25	SCREW,SHCS,M6X1,00X25	54	MHE3050-100	NUT,NYLON M3X,50
2	163989	BUSHING,EXHAUST DEFLECTOR	55	100298	PIN,SPRAL M3X30
3	163918	DEFLECTOR EXHAUST	56	MPPO30020	PIN,SPRAL M3X20MM
4	163930	PLATE CAP	57	123859	BUSHING,FLANGED ISOLATION
5	MSCS100-25	SCREW,SHCS,M6X1,00X25	58	MPW6.2	WASHER,SPECIAL
8	163948	FRAME CAP MACHINING	59	158612	LABEL,WARNING
9	105814	O-RING,1.929X,098	60	159722	LABEL,M88RH-2MCH FASTENER SPEC
10	163920	BUMPER,HEAD VALVE	61	MHE6100-100	NUT,ESN M6X1
11	163944	SPRING,HEAD VALVE	62	163960	BRACKET
12	163922	O-RING,2.487X,103XNBR	63	121406	LINER,NAIL GUIDE
13	163921	LOWER BODY,HEAD VALVE	64	166797	O-RING,.056X,080 NBR
14	163923	SEAL,HEAD VALVE	65	104981	LABEL,WARNING
15	163945	SEAL,FRAME/CAP	66	100261	SCREW,SHCS,M4X30
16	851606	O-RING,1.850X,210	67	121472	SPACER,PUSHER LATCH
17	163921	ASSEMBLY,PISTON/DRIVER	68	166782	MAGAZINE,PAD PRINT,F21PL
18	163924	SLEEVE,CYLINDER	69	166778	LATCH,PUSHER
19	173520	SEAL,CHECK	70	120927	LABEL,SENSOR SMALL (DR)
20	163955	RING,CYLINDER SLEEVE	71	163912	ASSEMBLY,END CAP
21	106718	O-RING,3.484X,139	72	163967	ROD GUIDE
22	89673	O-RING,2.550X,103	73	120878	SPRING, PUSHER LATCH
23	163956	SEAL,END CAP	74	MPV4	WASHER,PWN,M4
24	163943	END CAP PAINT	75	MSB6100-12	SCREW,SBHCS,M6X1,00X12
25	T50118	WASHER,PLAIN	76	121407	PIN,SPECIAL
26	MSC5080-20	SCREW,SOC HD, CAP M5 X 20	77	MHE4070-100	ELASTIC STOP NUT,M4
27	166781	SPRING,UPPER TRIP	78	163901	PUSHER
28	171432	LABEL,MAGNESIUM	79	115143	SPRING,CONSTANT FORCE
29	9R195676	FRAME,OVERMOLD	80	163902	HANDLE,PUSHER
30	107231	BUMPER,DRIVE	81	121052	SCREW,SHCS,M4X0,70X25
31	MCN-KIT3	KIT,METAL CONNECTOR ATTACHMENT	82	112630	SHIELD,DUST
32	163900	ARM,UPPER CONTACT	83	112631	SPRING,CLIP
33	MSC4070-16	SCREW,SHCS,M4X0,7X16	84	121071	CLIP,TRIP FOOT
34	163903	BUSHING,TRIP COVER	85	121070	FOOT,TRIP
35	163923	NOSE,F21PL	86	163958	PLUG,EXHAUST
36	166772	SPRING,CONTACT ARM	88	MSC8100-35	SCREW,SHCS,M6X1,00X35
37	106224	CASTING,HOUSING CONTACT	89	171354	ASSEMBLY,UTILITY HOOK
38	142941	ARM,LOWER CONTACT	90	171342	WASHER,UTILITY HOOK
39	121072	ASSEMBLY,TRIP FOOT	91	171338	COVER,TRIP
40	115230	SPRING,HOUSING	92	UB3811,2	PIN,SPROL - 5/32X3/4
41	166777	CASTING,PLUNGER	93	171340	MOUNT,UTILITY HOOK
42	MSC8125-30	SCREW,SHCS,M8X30	94	171341	SPRING,UTILITY HOOK
43	854004	WASHER,RUBBER-7	95	171339	HOOK,UTILITY
44	163977	PAWL			
45	163978	SPRING,CHECK PAWL			
46	149892	PIN,CHECK PAWL			
47	163983	GUIDE,ARM			
48	SE07	KIT,SEQUENTIAL TRIP CONVERSION			
49	CNTG5	KIT,CONTACT TRIP CONVERSION			
50	100387	SPRING,COMPRESSION			
51	TV46	KIT,TRIGGER VALVE			
52	171335	LABEL,WARNING,METAL CONNECTOR			
53	108562	SCREW,TRIGGER PIVOT			