

OPERATING INSTRUCTIONS AND PARTS MANUAL

MODEL 90/25

Stapler

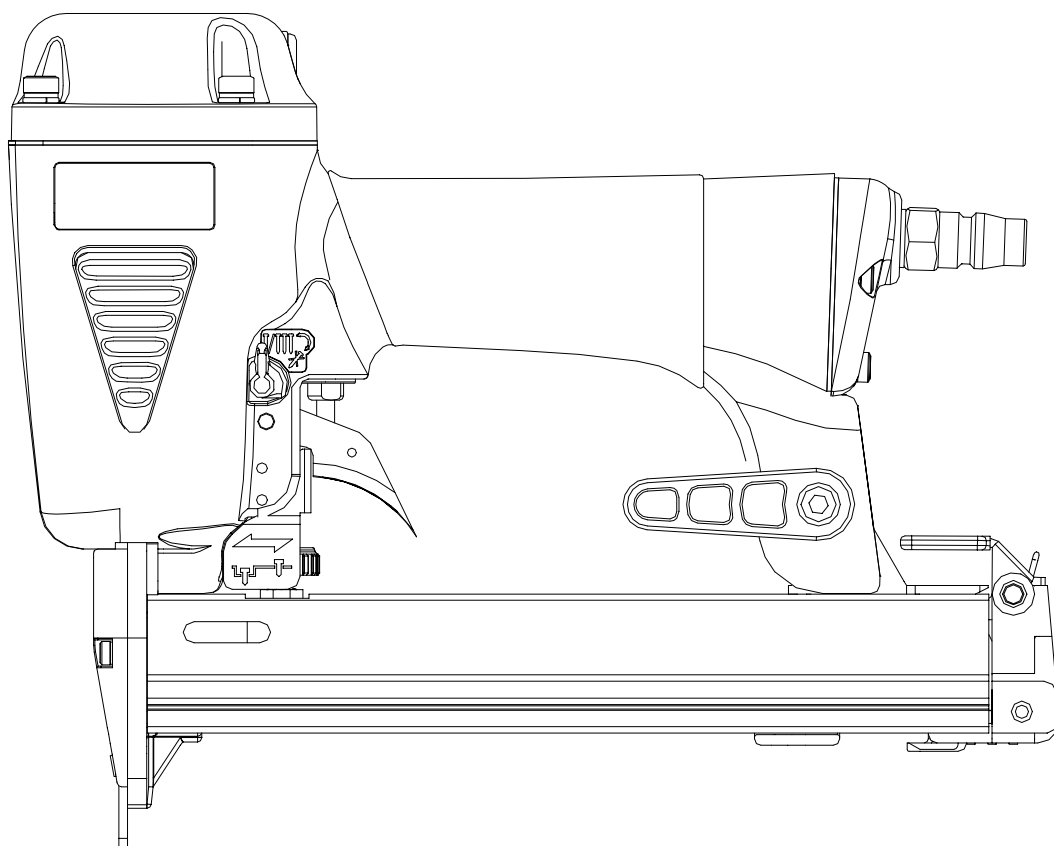

CAREFULLY READ THIS MANUAL BEFORE OPERATING TOOL

APLUS Pneumatic Corp.
NO.579, SEC. 1, SHEN LIN RD., TAYA, TAICHUNG CITY 428 TAIWAN, R.O.C.
Tel: 886-4-25602860 Fax: 886-4-25602859
Original instructions

OPERATING INSTRUCTIONS AND PARTS MANUAL

MODEL 90/25

Stapler

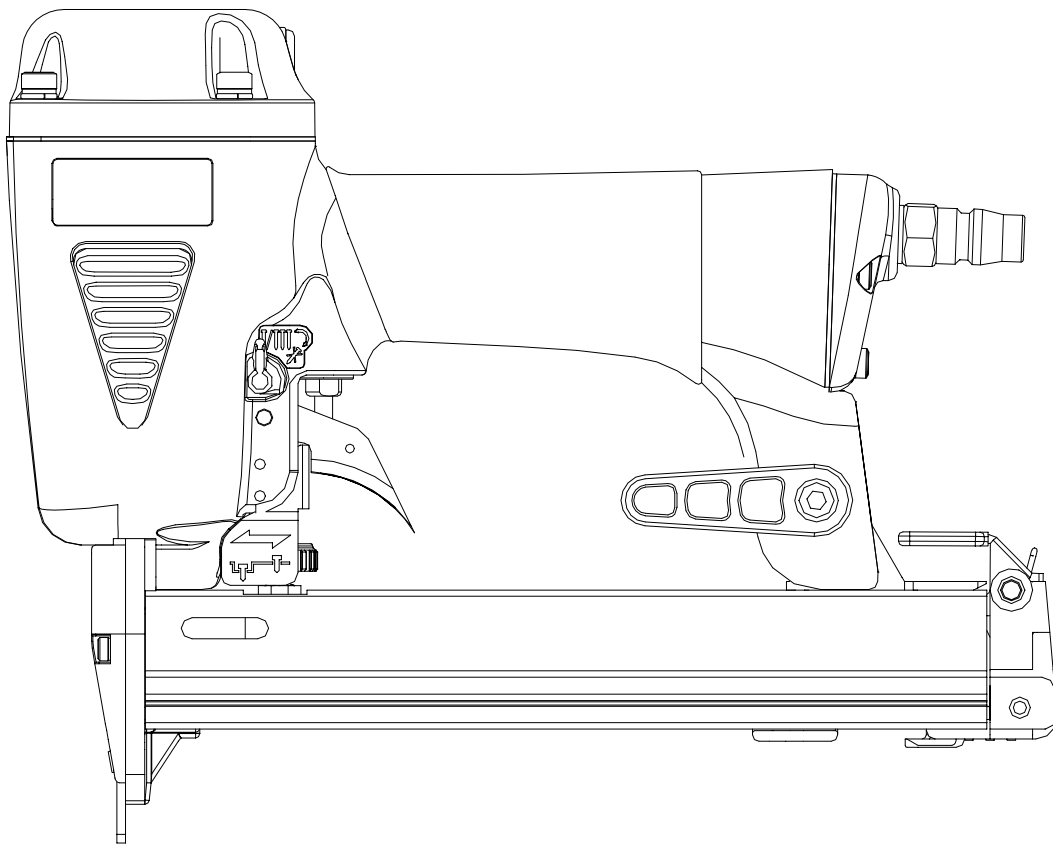

CAREFULLY READ THIS MANUAL BEFORE OPERATING TOOL

TOOL SPECIFICATIONS

MODEL OF TOOL	90/25
TOOL LENGTH	9.45" (240 mm)
TOOL HEIGHT	7.72" (196 mm)
TOOL WIDTH	2.17" (55 mm)
WEIGHT (WITHOUT FASTENERS)	2.65 lbs (1.2 kgs)
AIR INLET	1/4" NPT
COMPRESSED AIR :	
Maximum permissible operating pressure	110 PSIG (7.5 bar)
Recommended operating pressure range	60 ~ 100 PSIG (4 ~ 7 bar)
AIR CONSUMPTION.....	0.0174 scfm with 25 nails per minute @ 100 psi (6.9 bar)

Noise dB(A) :	
A-weighted sound pressure level LpA.....	80.52 dB(A)
A-weighted sound power level LwA.....	93.52 dB(A)
Measurement uncertainty: 3dB	
Vibration (m/s²) :	
Hand-arm vibration value.....	1.85 m/s ²
Measurement uncertainty: 1.5 m/s ²	

Warning:

The vibration emission during actual use of the power tool can differ from the declared total value depending on the ways in which the tool is used; and of the need to identify safety measures to protect the operator that are based on an estimation of exposure in the actual conditions of use (taking account of all parts of the operation cycle such as the times when the tool is switched off and when it is running idle in addition to the trigger time).

List of fasteners for 90/25 :

Crown	Thickness	Width	MAGAZINE
5.8 mm , 0.23 "	1.0 mm , 0.04 "	1.25 mm , 0.05 "	100 pcs

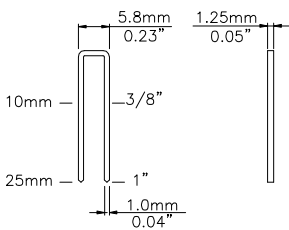

Foreword:

This pneumatic stapler is designed for moulding, hobbies and most other jobs requiring a hammer. Its well balanced, ergonomic, comfort non-slip cushioned grip and heavy duty driving compatible staples to proper applications. Features long protruding nose to nail/staple into tight corners/groves, easy loading magazine are exactly what master needed. No more painful hammering and ensure you as satisfactory tackle and enjoy work.

Suitable applications:

Wood and wood like applications, MDF, Hobby/Craft, fine decorative trim, beading and moulding. Tongue & Groove paneling. Cabinet and plywood assembly, garden furniture and trellis work, door/window assembly, hardwood flooring, paneling and trim. Picture/mirror frames. Sub-flooring and many more.... This electric tool is restricted to using on wood, wood like products, leather and material of paper. Any other material is forbidden.

Caution:

Not suitable for stapling or nailing into concrete, masonry bricks or steel. Do not fire if nails are jammed, as this will cause damage to the driver blade.



Indicates an imminently hazardous situation which, if not avoided, will result in death or serious injury.

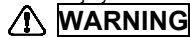

Indicates an potentially hazardous situation which, if not avoided, will result in death or serious injury.

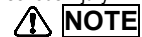

Alerts the operator to useful information.

SAFETY INSTRUCTIONS



1. Read this manual and understand all safety instructions before operation the tool. if you have any questions, please contact our authorized representatives.
2. Only those fasteners listed in the operating instructions may be used in the fastener driving tools.
3. Only the main energy and the lubricants listed in the operating instructions may be used.
4. Fastener driving tools marked with an inverted equilateral triangle standing on one point may only be used with an effective safety yoke.
5. Fastener driving tools equipped with contact actuation or continuous contact actuation, with the symbol " Do not use on scaffoldings, ladders", shall not be used for specific application for example:
 - when changing one driving location to another involves the use of scaffoldings, stairs, ladders, or ladder alike constructions, e.g. roof laths,
 - closing boxes or crates,
 - fitting transportation safety systems e.g. on vehicles and wagons.
6. For the maintenance of fastener driving tools, only spare parts specified by the manufacturer or his authorized representative shall be used.
7. Repairs shall carried out by agents authorized by the manufacturer or by other specialists ,having due regard to the information given in the operating instruction.

8. Stands for mounting the fastener driving tools to a support for example a work table shall be designed and constructed by the stand manufacturer in such a way that the fastener driving tool can be safely fixed for the intended use, thus for example avoiding damage, distortion or displacement.
9. Fastener driving tools operated by compressed air shall only be connected to compressed air lines where the maximum allowable pressure cannot be exceed by a factor of more than 10%, which can for example be achieved by a pressure reduction valve which includes a downstream safety valve.
10. When using fastener driving tools operated by compressed air, particular attention must be paid to avoid exceeding the maximum allowable pressure.
11. When using fastener driving tools operated by compressed air should only be operated at the lowest pressure required for the work process at hand, in order to prevent unnecessarily high noise levels, increased wear and resulting failures.
12. Hazards caused by fire and explosion when using oxygen or combustible gases for operating compressed air operated fastener driving tools.
13. Carry the fastener driving tool at workpiece using only the handgrip, and never with the trigger actuated. Never carry the tool by the hose or pull the hose to move the tool.

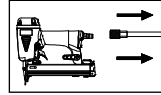

14. Disconnect the tool from air supply before cleaning jams, servicing, adjusting, and during non-operation.



15. Wear eye protection.

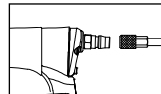

16. Do not use a check valve or any other fitting which allows air to remain in the tool.



17. Do not place your hand or any part of your body in the fastener discharge area of the tool when connecting or disconnecting air supply.



18. Never point tool at yourself or at any other person.



19. Do not use on scaffoldings, ladders.

AIR SUPPLY AND CONNECTION



- Many air tool users find it convenient to use oiler to help provide oil circulation through tool and increase the efficiency and useful life of the tool. Check oil level in the oiler daily.
- Many air tool user find it convenient to use a filter to remove liquid and impurities which can rust or wear internal parts of the tool. A filter also increase the efficiency and useful of the tool. The filter must be checked on a daily basis and if necessary drained.
- For better performance, install a 3/8" quick connector (1/4" NPT threads) with an inside diameter of .315" on your tool and a 3/8" quick coupler on the air hose.

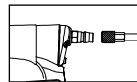
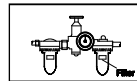
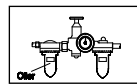

The following illustration shows the correct mode of connection to the air supply system which will increase the efficiency and useful life of the tool

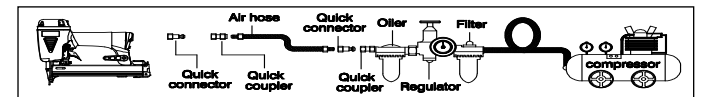

LUBRICATION AND MAINTENANCE

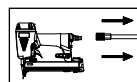

- Disconnect the air supply from the tool before lubricating.

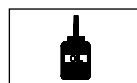

- Your tool requires lubrication before you use it for the first time.

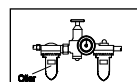

- Wipe off excessive oil at the exhaust. Excessive oil will damage O-rings of tool. If in-line oiler is used, manual lubrication through the air inlet is not required on a daily basis.



- Turn the tool so the inlet is facing up and put one drop of high speed spindle oil, UNOCAL RX22, or 3-IN-1 oil into air inlet. Never use detergent oil or additives. Operate the tool briefly after adding oil.

LOADING THE TOOL

⚠ WARNING



- Do not place your hand or any part of your body in the fastener discharge area of the tool when connecting or disconnecting air supply.



⚠ WARNING

- Never point any operational fastener driving tool at yourself or at any other person.

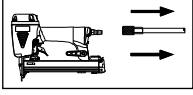

1. Disconnect air hose.

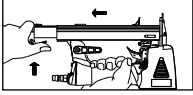

2. Pull back on the fastener pusher until locked.

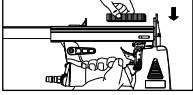

3. Insert a stick of fastener into the magazine. Make sure the pointed ends of the fasteners are loaded with the points up. Also make sure fasteners are not dirty or damaged.

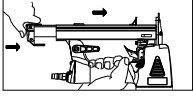

4. Push the magazine cover forward until the catches.

OPERATING THE TOOL

⚠ WARNING



Protect your eyes and ears. wear z87.1 safety glasses with side shields. wear hearing protection. Employers and users are responsible for ensuring the user or anyone near the tool wear this safety protection.

⚠ NOTE

Check and replace any damaged or worn components on the tool. The safety warning labels on the tool must also be replaced if they are not legible.

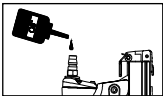

Fig.1

1. Add a few drops of UNOCAL RX22 or 3-in-1 oil into the air inlet. (See Fig. 1)

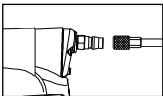

Fig.2

2. Attach a high flow quick connect fitting to the tool. (See Fig. 2)

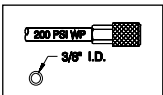

Fig.3

3. Empty the magazine.
4. Connect the tool to an air compressor using a 3/8" I.D hose. Make sure the hose has a rated working pressure exceeding 200 PSI (13.8 bar) and a female quick coupler. (See Fig. 3)

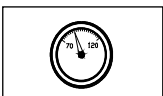

Fig.4

5. Regulate the air pressure to obtain 70 PSI (4.8 bar) the tool. Check the operation of the contact safety trip mechanism following the instructions in this manual. (See Fig. 4)



Fig.5

6. Disconnect the air supply from the tool.
7. Load nails into your tool following the instructions in this manual. (See Fig. 5)

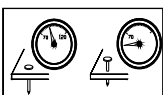

Fig.6

8. Reconnect the air supply to the tool.
9. Test for proper nail penetration by driving nails into a sample piece of wood. If the nails do not achieve the desired penetration, adjust the air pressure to a higher setting until the desired penetration is achieved. Do not exceed 125 PSI (8.6 bar) at the tool. (See Fig. 6)

ACTUATION SYSTEM

SEQUENTIAL ACTUATION MECHANISM :

□ SINGLE

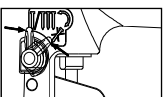

- Unlock the safety when preparing to operate this tool.
- Lock the safety when finishing the work.

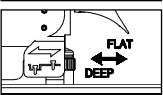

- Rotate the adjustment wheel forward or backward to adjust the nail depth.
- Turn to the Deep, more depth.
- Turn to the Flat, less depth.



- The operator requires finger to be off the trigger and the nose of the tool to be placed on the work piece.

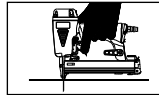

- The sequential actuation trip mechanism is then depressed against the work piece and the trigger is pulled to drive a fastener.



- The trigger is released after each fastener is driven.
- Move the tool to next location and the above procedure repeated.

□ BUMP ACTUATION MECHANISM

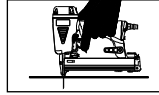

- The operator is required to be off the workpiece and finger to depress the trigger first.



- The bump actuation trip mechanism is then depress against the workpiece and the trigger is pulled to drive a fastener.
- Leave trigger depressed while moving the tool to next location.

CHECKING OPERATION OF CONTACT SAFETY TRIP MECHANISM:

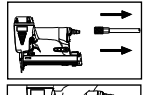

- Disconnect the air supply from the tool.

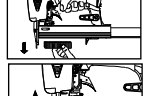

- Empty the magazine.

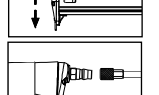

- Make sure the trigger and contact safety trip mechanism move up and down without any sticking.

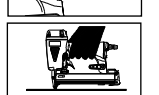

- Connect air supply to the tool.



- Depress the contact safety trip mechanism against the workpiece without pulling the trigger. The tool must not cycle. Never use the tool if a cycle occurs.

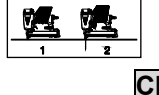

- Hold the tool clear of the workpiece. The contact safety trip mechanism should return to its original down position. Pull the trigger. The tool must not cycle. Never use the tool if a cycle occurs.

- Depress the contact safety mechanism again the workpiece and pull the trigger, the tool must cycle.

CLEARING A JAM FROM THE TOOL

⚠ WARNING

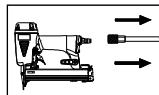

Disconnect the tool from air compressor before adjusting, clearing jams, servicing, relocating and during non-operation.

1. Fastener jammed in fastener discharge area:
 - Disconnect tool from air hose.
 - Grab jammed fastener with pliers and remove.

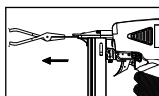

2. Fastener jam inside magazine:
 - Disconnect air tool from air hose.
 - Pull back on fastener pusher until locked.
 - Removed jammed fastener.
 - Release fastener pusher.

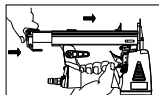

CLEANING THE TOOL

⚠ DANGER ⚠



Never use gasoline or other flammable liquids to clean the tool. Vapors in the tool will ignite by a spark and cause the tool to explode and result in death or serious personal injury.

⚠ NOTE

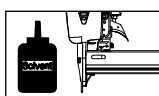

Solvents used to clean the nose of the tool and contact safety trip mechanism may soften the tar on the shingles and cause the buildup to be accelerated. Make sure to dry the tool thoroughly after cleaning and before operating the tool again.

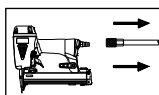

1. Disconnect the air supply from the tool.

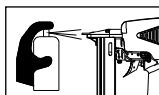

2. Remove tar buildup with kerosene #2 fuel oil or diesel fuel. Do not allow solvent to get into the cylinder or damage may occur. Dry off the tool completely before use.

90/25D02 (UC/S3-02)

a

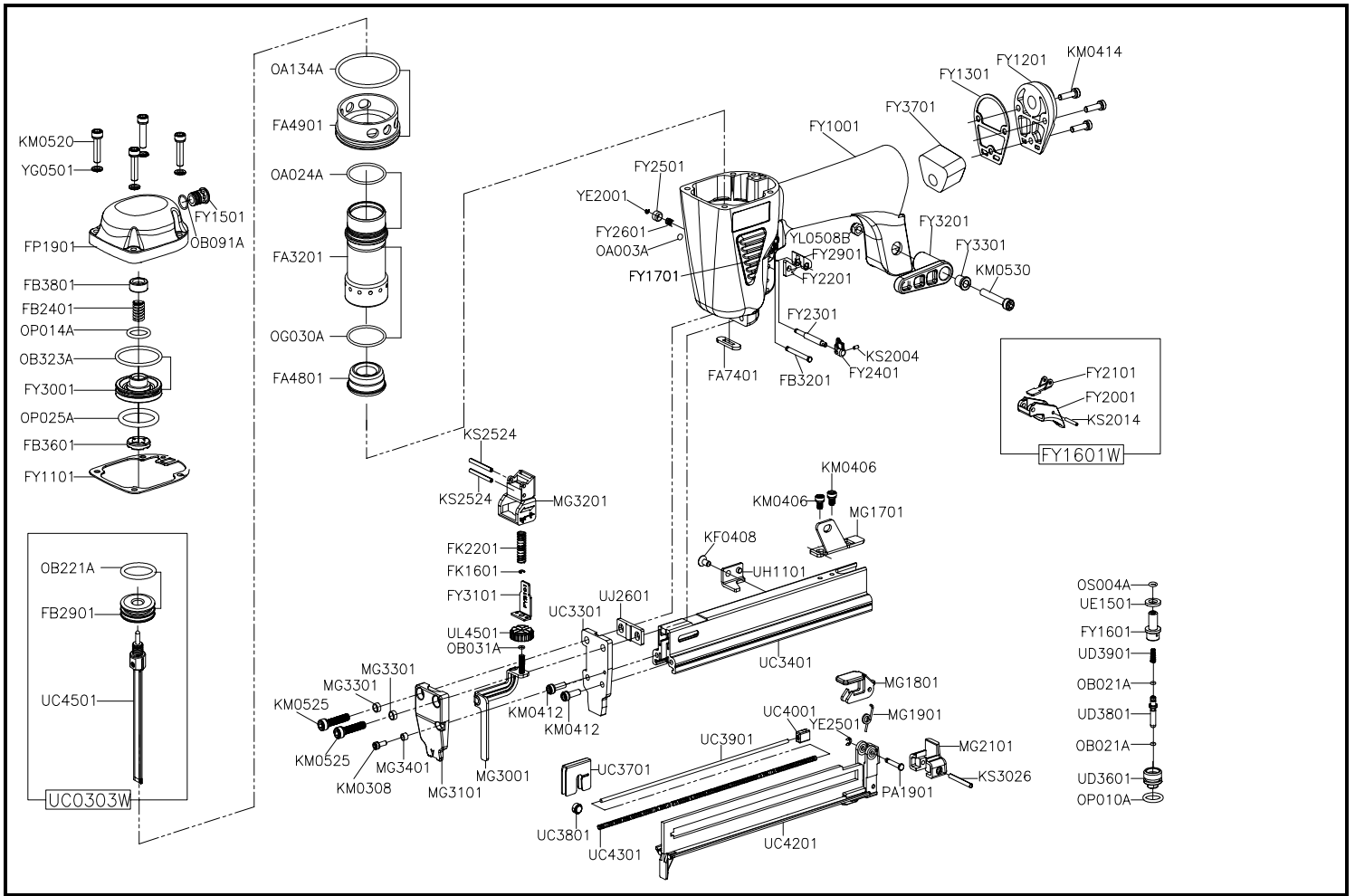

Part_No	Description	Spec	Q'ty	Part_No	Description	Spec	Q'ty	Part_No	Description	Spec	Q'ty
FA3201	CYLINDER		1	FY3201	HOOK		1	OB221A	O-RING	22x3	1
FA4801	BUMPER		1	FY3301	RING		1	OB323A	O-RING	31.8x2.4	1
FA4901	COLLAR		1	FY3701	MUFFLER		1	OG030A	O-RING	G30	1
FA7401	NOZZLE		1	KF0408	FLAT HD.BOLT	M4x0.7 - 8L	1	OP010A	O-RING	P10	1
FB2401	COMPRESSION SPRING		1	KM0308	HEX.SOC.HD.BOLT	M3x0.5 - 8L	1	OP014A	O-RING	P14	1
FB2901	MAIN PISTON		1	KM0406	HEX.SOC.HD.BOLT	M4x0.7 - 6L	2	OP025A	O-RING	P25(1A)	1
FB3201	PIN		1	KM0412	HEX.SOC.HD.BOLT	M4x0.7 - 12L	2	OS004A	O-RING	S-4	1
FB3601	PISTON STOP		1	KM0414	HEX.SOC.HD.BOLT	M4x0.7 - 14L	3	PA1901	PIN		1
FB3801	PISTON STOP		1	KM0520	HEX.SOC.HD.BOLT	M5x0.8 - 20L	4	UC0303W	DRIVER ASSY.		1
FK1601	C-RING		1	KM0525	HEX.SOC.HD.BOLT	M5x0.8 - 25L	2	UC3301	COVER PLATE		1
FK2201	COMPRESSION SPRING		1	KM0530	HEX.SOC.HD.BOLT	M5x0.8 - 30L	1	UC3401	MAGAZINE CAP		1
FP1901	CYLINDER CAP		1	KS2004	SPRING PIN	§ 2-4L	1	UC3701	PUSHER		1
FY1001	BODY		1	KS2014	SPRING PIN	§ 2-14L	1	UC3801	PUSHER PIN		1
FY1101	CAP SEAL		1	KS2524	SPRING PIN	§ 2.5-24L	2	UC3901	GUIDE STEM		1
FY1201	END CAP		1	KS3026	SPRING PIN	§ 3-26L	1	UC4001	ROLL SET		1
FY1301	END CAP SEAL		1	MG1701	SUPPORT		1	UC4201	MAGAZINE SEAT SET		1
FY1501	SCREW		1	MG1801	LATCH		1	UC4301	PUSHER SPRING		1
FY1601	TRIGGER VALVE SEAT		1	MG1901	SPRING		1	UC4501	DRIVER SET		1
FY1601W	TRIGGER ASSY.		1	MG2101	COVER		1	UD3601	TRIGGER VALVE GUIDE		1
FY1701	RUBBER PLATE		2	MG3001	WORK CONTACTING ELEMENT		1	UD3801	TRIGGER VALVE STEM		1
FY2001	TRIGGER		1	MG3101	PLATE		1	UD3901	COMPRESSION SPRING		1
FY2101	CONTACT LEVER		1	MG3201	SAFETY SET		1	UE1501	SEAL		1
FY2201	SWITCH PLATE		1	MG3301	CAP		2	UH1101	MAGAZINE RETAINER		1
FY2301	ROLLER PIN		1	MG3401	CAP		1	UJ2601	GUIDE PLATE		1
FY2401	REVOLVE BOTTON		1	OA003A	O-RING	ARP568-003	1	UL4501	ADJUSTING WHEEL		1
FY2501	SPRING CAP		1	OA024A	O-RING	ARP568-024	1	YE2001	E-RING	§ 2.0	1
FY2601	COMPRESSION SPRING		1	OA134A	O-RING	ARP568-134	1	YE2501	E-RING	§ 2.5	1
FY2901	LOCK		1	OB021A	O-RING	1.8x1.2	2	YG0501	SPRING WASHER	§ 5	4
FY3001	HEAD VALVE PISTON		1	OB031A	O-RING	3x1	1	YL0508B	LOCK NUT	M5x0.8	1
FY3101	SAFETY		1	OB091A	O-RING	9x1	1				

★☆☆ If you need to order parts, please mark both Parts No. and Description. ★☆☆